

GROUNDHOG ANCHOR AND SUPPORT SYSTEMS			
RECOMMENDED DESIGN LOADS			
ANCHOR TYPE MODEL NO.	SHAFT LENGTH	FLIGHT AUGER DIAM.	ALLOWABLE LOAD (LBS)
12/12	12'-0"	12"	5000
8/12	8'-0"	12"	5000
8/9	8'-0"	9"	3000
6/8	6'-0"	8"	2000

Notes:

1. Ultimate loads were based on a vertical applied load that created a 0.1 inch displacement.
National Testing Laboratories Limited, report date June 07, 2010.
2. Piles have been tested according to the requirements of ASTM D1143.
3. Piles comply to the requirements of:
 - a. Clause 4.2.3.8 (1)
 - b. Sentence 4.2.3.10 (1)
 - c. Sentence 4.2.4.1 (1)
 - d. Sentence 9.4.1.1 (1)(c)(i)
of the Manitoba Building Code (2011)
4. Safety factor applied to ultimate load=2.
5. Test soil type was firm to stiff clay – (1500 psf bearing capacity)
6. Loads values will have to be revised for different soil conditions.
Engineer to be contacted if site soil conditions are not firm to stiff clay.
Engineer shall be retained to calculate the loads being applied.
7. Site specific field modifications to be undertaken by registered installers of Groundhog Anchors only.

WOLFROM ENGINEERING LTD CONSULTING ENGINEERS 345 WARDLAW AVENUE WINNIPEG, CANADA R3L 0L5 (204)452-0041 FAX: 284-8680 E-Mail: info@wolfromeng.com	DATE JUNE 01, 2021	SEAL
	SCALE AS NOTED	
JOB TITLE DESIGN CRITERIA GROUNDHOG ANCHOR AND SUPPORT SYSTEMS NEW ORDER ENTERPRISES	FILE NO. W21260	
	DRAWING NO. SK-1	

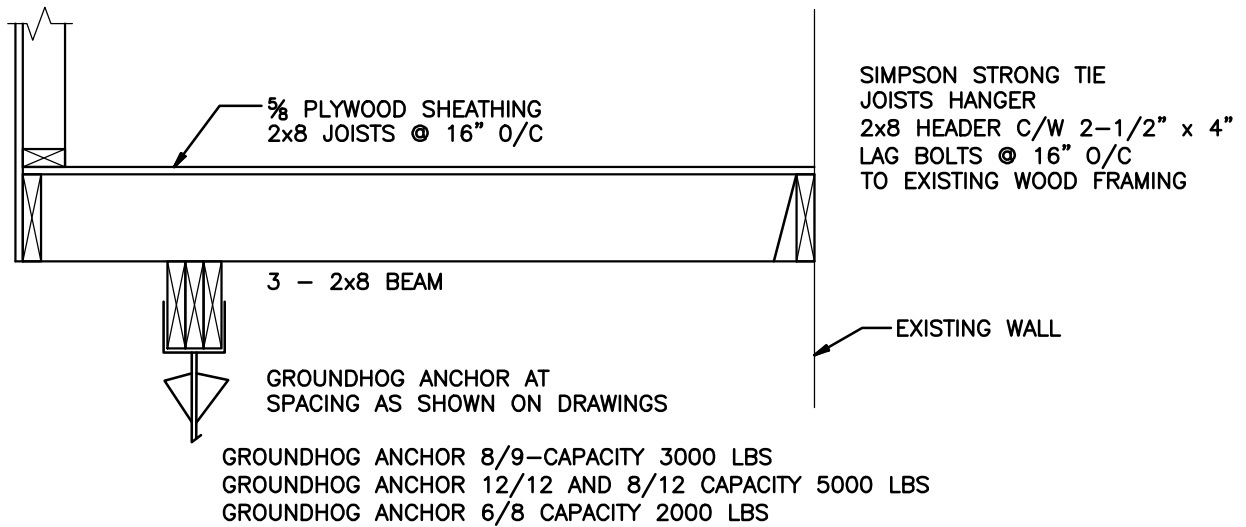

General Notes:

This sketches and drawings are not site specific.
Soil conditions may vary from site to site. Building
authorities will require site specific drawings.
The Engineer has not been retained to provide drawings or supervision.

Design Loads

Roof: Snow Load = 26 psf
Dead Load = 8 psf

Floor: Live Load = 40 psf
Dead Load = 10 psf

All wood framing to be in accordance with CSA 086.
All timber to be #2 SPF or better.

GROUNDHOG ANCHOR TO BE INSTALLED IN FIRM TO STIFF CLAY OR DENSE SAND

<p>WOLFROM ENGINEERING LTD</p> <p>CONSULTING ENGINEERS 345 WARDLAW AVENUE WINNIPEG, CANADA R3L 0L5 (204)452-0041 FAX: 284-8680 E-Mail: info@wolfromeng.com</p>	<p>DATE</p> <p>JUNE 01, 2021</p>	<p>SEAL</p>
	<p>SCALE</p> <p>AS NOTED</p>	
<p>JOB TITLE</p> <p>TYPICAL CROSS SECTION GROUNDHOG ANCHOR AND SUPPORT SYSTEMS NEW ORDER ENTERPRISES</p>	<p>FILE NO.</p> <p>W21260</p>	
	<p>DRAWING NO.</p> <p>SK-2</p>	